

## 2072: Engraved Mixing Container Base

### Graduation Directions / Lines

1. FILL TO LINE WITH COLD WATER
2. ADD CONTENTS OF ONE PACKET
3. SHAKE WELL AND DRINK

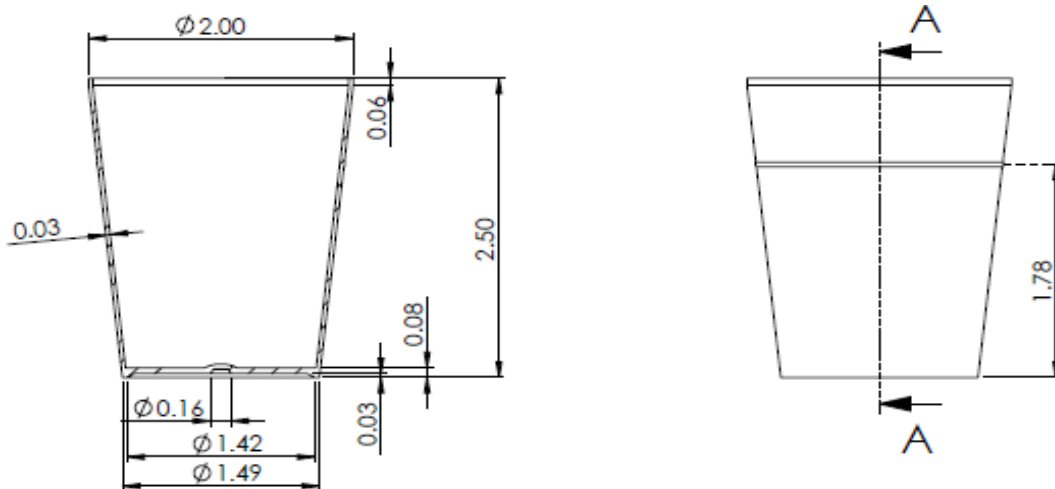

### Engraved Container

- Material is fabricated of Polypropylene. (natural)
- Engraved markings are located on the inside portion of the cup, raised 0.003".
- Dosage cups / mixing containers provide ease of transporting and dispensing of liquid medications, crushed medications and tablets.

### Mixing Container Lid: 2071 (order separate)

Hudson Valley Plastics 85 Charles Colman BLVD Pawling NY 12564 P: 845-855-1201 hudsonvalleyplastics.com  
Manufacturer reserves the right to make design and dimension changes without notice. Drawings are not drawn to scale.